

## 00U111N Series - Union

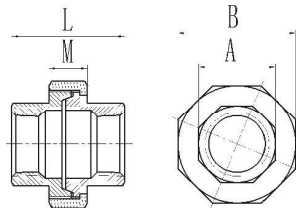

Size In	Part No.		Dimension(in)				Weight LB
	304	316	B	A	L	M	
1/8	400U111N018	600U111N018	0.984 ± 0.016	0.512 ± 0.016	1.063 ± 0.039	0.512 ± 0.016	0.12
1/4	400U111N014	600U111N014	1.201 ± 0.016	0.689 ± 0.016	1.220 ± 0.039	0.531 ± 0.016	0.15
3/8	400U111N038	600U111N038	1.346 ± 0.020	0.827 ± 0.020	1.339 ± 0.039	0.630 ± 0.016	0.22
1/2	400U111N012	600U111N012	1.476 ± 0.020	1.004 ± 0.020	1.496 ± 0.039	0.650 ± 0.016	0.27
3/4	400U111N034	600U111N034	1.831 ± 0.020	1.240 ± 0.020	1.528 ± 0.039	0.728 ± 0.020	0.39
1	400U111N010	600U111N010	2.067 ± 0.020	1.516 ± 0.020	1.870 ± 0.039	0.748 ± 0.020	0.61
1 1/4	400U111N114	600U111N114	2.539 ± 0.024	1.870 ± 0.024	2.106 ± 0.039	0.866 ± 0.020	0.92
1 1/2	400U111N112	600U111N112	2.776 ± 0.024	2.146 ± 0.024	2.244 ± 0.039	0.925 ± 0.020	1.25
2	400U111N020	600U111N020	3.484 ± 0.031	2.638 ± 0.031	2.547 ± 0.039	1.024 ± 0.024	1.87
2 1/2	400U111N212	600U111N212	4.272 ± 0.039	3.150 ± 0.031	2.815 ± 0.039	1.102 ± 0.024	2.69
3	400U111N030	600U111N030	4.673 ± 0.039	3.846 ± 0.039	3.268 ± 0.039	1.220 ± 0.028	3.88
4	400U111N040	600U111N040	5.807 ± 0.039	4.787 ± 0.039	3.386 ± 0.039	1.339 ± 0.028	6.27

## OXB111N Series - Cross

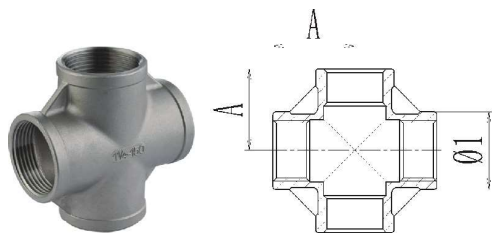

Size In	Part No.		Dimension(in)			Weight LB
	304	316	§ 1	A	LB	
1/8	400X111N018	600X111N018	0.630 ± 0.012	0.705 ± 0.039	0.11	
1/4	400X111N014	600X111N014	0.787 ± 0.012	0.764 ± 0.039	0.33	
3/8	400X111N038	600X111N038	0.984 ± 0.012	0.917 ± 0.039	0.31	
1/2	400X111N012	600X111N012	1.181 ± 0.020	1.138 ± 0.039	0.44	
3/4	400X111N034	600X111N034	1.386 ± 0.020	1.280 ± 0.039	0.67	
1	400X111N010	600X111N010	1.791 ± 0.020	1.437 ± 0.039	1.09	
1 1/4	400X111N114	600X111N114	2.091 ± 0.020	1.713 ± 0.039	1.60	
1 1/2	400X111N112	600X111N112	2.394 ± 0.020	1.913 ± 0.039	2.04	
2	400X111N020	600X111N020	2.925 ± 0.020	2.224 ± 0.039	3.18	
2 1/2	400X111N212	600X111N212	3.555 ± 0.039	2.701 ± 0.039	5.46	
3	400X111N030	600X111N030	4.201 ± 0.039	3.098 ± 0.039	7.62	
4	400X111N040	600X111N040	5.236 ± 0.039	3.819 ± 0.039	11.14	

## ORC111N Series - Round Cap

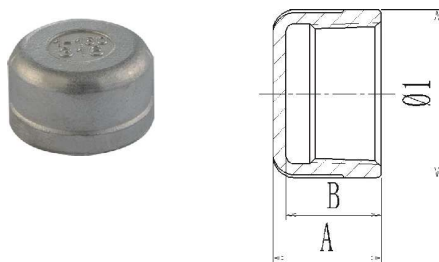

Size In	Part No.		Dimension(in)				Weight LB
	304	316	§ 1	A	B	LB	
1/8	40RC111N018	60RC111N018	0.630 ± 0.039	0.610 ± 0.016	0.461 ± 0.016	0.03	
1/4	40RC111N014	60RC111N014	0.780 ± 0.039	0.866 ± 0.016	0.728 ± 0.016	0.07	
3/8	40RC111N038	60RC111N038	0.992 ± 0.039	0.965 ± 0.016	0.846 ± 0.016	0.12	
1/2	40RC111N012	60RC111N012	1.173 ± 0.039	1.083 ± 0.020	0.957 ± 0.020	0.16	
3/4	40RC111N034	60RC111N034	1.425 ± 0.039	1.102 ± 0.020	0.961 ± 0.020	0.23	
1	40RC111N010	60RC111N010	1.783 ± 0.039	1.280 ± 0.020	1.154 ± 0.020	0.36	
1 1/4	40RC111N114	60RC111N114	2.087 ± 0.039	1.287 ± 0.024	1.142 ± 0.024	0.54	
1 1/2	40RC111N112	60RC111N112	2.362 ± 0.039	1.417 ± 0.024	1.220 ± 0.024	0.64	
2	40RC111N020	60RC111N020	2.913 ± 0.039	1.480 ± 0.031	1.272 ± 0.031	1.00	
2 1/2	40RC111N212	60RC111N212	3.327 ± 0.039	1.693 ± 0.039	1.421 ± 0.039	1.65	
3	40RC111N030	60RC111N030	4.331 ± 0.039	1.870 ± 0.039	1.614 ± 0.039	2.91	
4	40RC111N040	60RC111N040	5.476 ± 0.039	2.043 ± 0.039	1.764 ± 0.039	4.85	

## OLN111N Series - Lock Nut

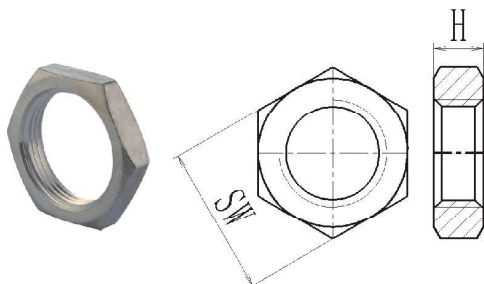

Size In	Part No.		Dimension(in)			Weight LB
	304	316	H	SW	LB	
1/8	40LN111N018	60LN111N018	0.244 ± 0.016	0.591 ± 0.020	0.01	
1/4	40LN111N014	60LN111N014	0.236 ± 0.016	0.701 ± 0.020	0.01	
3/8	40LN111N038	60LN111N038	0.244 ± 0.016	0.945 ± 0.020	0.01	
1/2	40LN111N012	60LN111N012	0.276 ± 0.020	1.169 ± 0.031	0.02	
3/4	40LN111N034	60LN111N034	0.276 ± 0.020	1.339 ± 0.031	0.03	
1	40LN111N010	60LN111N010	0.354 ± 0.020	1.673 ± 0.031	0.05	
1 1/4	40LN111N114	60LN111N114	0.433 ± 0.024	2.047 ± 0.031	0.09	
1 1/2	40LN111N112	60LN111N112	0.441 ± 0.024	2.283 ± 0.039	0.10	
2	40LN111N020	60LN111N020	0.512 ± 0.024	2.835 ± 0.039	0.17	

Dimensional tolerances are as per ISO 8062-3:2007 CT7 ( for Castings) and ISO 2768-1:1989/M (for Machining)